



This aluminum profile and diffuser is designed for mud-in application along the bottom of drywall. It provides a soft downward light reveal from a hidden LED light source that gives your baseboard installation a professional finished appearance.

The included frosted diffusing cover presses in from the underside of the channel, for easy access, installation and servicing. The channel is powder-coated white.

- Accommodates any LED 10 mm strips wide (or narrower)
- Available in 3 meters (9.84 feet)
- This product can be cut to any length.
- Will accommodate drywall up to 5/8 inch thick
- This channel requires drywall mudding for installation.

Special Requests:

You may do it yourself or ask Lumicrest to cut this product to any length or also have your lights delivered pre-assembled in the channel.

If you have questions about installing LED strip, how to connect multiple reels, how many power supplies you need, or anything else, give us a call. We'll help you work it out!

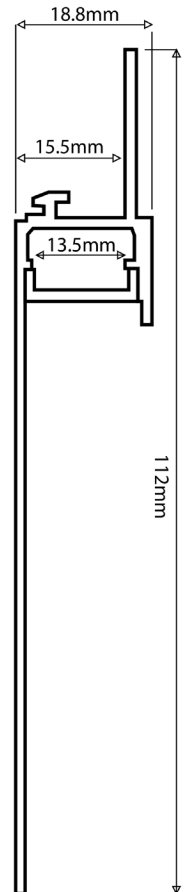

SKU	Finish	Length
1760-drybb-3m	White	3 m (9.84 ft)

Scale 1:1

Recommended Lighting Options Flexible White & RGBWW LED Strip

Pro Series: Ultra-Narrow White Dotless



Specifications:

CCT: 2700K, 3000K **Voltage:** 24 volt DC
Lumens: 600 l/m **CRI:** 90+
Watts: 6 w/m
Cutable: every 1.4 cm (0.55 in)
 - Perfect for under-stairs, shelves and other bright accents.
 - Optional waterproofing available – ask us.
 - Secure 3M self-adhesive backing.

Dimensions:

Length: 5 meters (16.4 ft)
Width: 5 mm (0.2 in)

SKU	LED	Power
1556, 1557	White	24v

Spectra™ High CRI White Dotless



Specifications:

CCT: ranged 2200K to 6000K **Voltage:** 24 volt DC
Lumens: 2200K: 337 l/m to 6000K: 580 l/m **CRI:** 95+
Watts: 4.5 w/m (accent)
Cutable: every 50mm (2in) to 62.5 mm (~2.45 in)
 - Superb light quality and super-smooth appearance.
 - Available in 7 CCT and 3 lumen intensities per.
 - Secure 3M self-adhesive backing.

Dimensions:

Length: 5 meters (16.4 ft)
Width: 10 mm (0.4 in)

SKU	LED	Power
1200 to 1218	White	24v

FilmPro 360 Full Colour RGB +White



Specifications:

CCT: RGB, 2700K, 6500K **Voltage:** 24 volt DC
Lumens: R: 312, G: 768, B: 120, 2700K: 456, 6000K: 552
Watts: 24 w/m **CRI:** 95+
Cutable: every 5 cm (in)
 - Combines color-changing RGB + warm and cool white.
 - High density LEDs enables use in shallow channels.
 - Secure Tesa self-adhesive backing.

Dimensions:

Length: 5 meters (16.4 ft)
Width: 12 mm (0.47 in)

Requires non-dimmable power supply and RGB controller see MI-Boxer options. For professional use: DMX controller.

SKU	LED	Power
1304-FSI-RGBWW	RGB+WW	24v

More lighting options are available at : www.lumicrest.com

Recommended Power Supply Options 24V Constant Voltage Power Supplies

60 Watt MeanWell Plug-In (OWA-60)



Specifications:

Input Voltage: 100-240V AC, 50/60 Hz
Output: 24V DC, 2.5 A (60 watts)
Certifications: Class 2, current limited, cETL electrical safety approved
Rated: For dry and damp locations, IP67
 - NEMA Type A 2-prong plug to DC barrel connector
 - 5 ft non-detachable AC power cord included

Dimensions:

Length: 131 mm (5.2 in)
Width: 53 mm (2.1 in)
Height: 35 mm (1.4 in)
Weight: 484 g (1.07 lbs)

SKU	Finish	Power
451-ps-24v60w	Grey	60w 24v

90 Watt MeanWell Plug-In (OWA-90)



Specifications:

Input Voltage: 100-240V AC, 50/60 Hz
Output: 24V DC, 3.75 A (90 watts)
Certifications: Class 2, current limited, cETL electrical safety approved
Rated: For dry and damp locations, IP67
 - NEMA Type A 2-prong plug to DC barrel connector
 - 5 ft non-detachable AC power cord included

Dimensions:

Length: 171 mm (6.7 in)
Width: 63 mm (2.5 in)
Height: 37.5 mm (1.5 in)
Weight: 782 g (1.72 lbs)

SKU	Finish	Power
423-ps-24v90w	Grey	90w 24v

60 Watt Non-Dim Hardwire



100V - 277V AC INPUT

DC OUTPUT



Specifications:

Input Voltage: 120V AC, 50/60 Hz
Output: 24V DC, 4.0 A (60 watts)
Certifications: Class 2, current limited, cETL electrical safety approved
Rated: For dry, and damp locations
 - Multiple knockouts on both input and output sides (6 total)

Dimensions:

Length: 160 mm (6.3 in)
Width: 46 mm (1.8 in)
Height: 35 mm (1.4 in)
Weight: 368 g (0.81 lbs)

SKU	Finish	Power
1764-ps-nondim-24v60w	Black	60w 24v

Recommended Power Supply Options 24V Constant Voltage Power Supplies

96 Watt Non-Dim Hardwire



100V - 277V AC INPUT

DC OUTPUT



Specifications:

Input Voltage: 120V AC, 50/60 Hz
Output: 24V DC, 4.0 A (96 watts)
Certifications: Class 2, current limited, cETL electrical safety approved
Rated: For dry, and damp locations
 - Multiple knockouts on both input and output sides (6 total)

Dimensions:

Length: 160 mm (6.3 in)
Width: 46 mm (1.8 in)
Height: 35 mm (1.4 in)
Weight: 368 g (0.81 lbs)

SKU	Finish	Power
1765-ps-nondim-24v96w	Black	96w 24v

96 Watt Dimmable Hardwire



Specifications:

Input: 110 to 277V AC, 50/60 Hz
Output: 24V DC, 4.0 A (96 watts) PF .95
Dimming: MLV, ELV and 0-10V dimmers
Dimming Range: 100% to 0.1%
Certifications: cUL certified and Class 2 protected
Rated: For dry, damp and wet locations
 - Adjustable Output Voltage: 17V to 25V
 - Adjustable PWM Frequency 4k - 20k Hz (flicker-free)
 - No minimum load requirement

Dimensions:

Length: 158 mm. (6.2 in)
Width: 120.5 mm. (4.7 in)
Height: 42 mm. (1.7 in)
Weight: 850 g (1.87 lbs)

SKU	Finish	Power
1551-ps-dim-24v96w	Black	96w 24v

192 Watt Dimmable Hardwire



Specifications:

Input: 110 to 277V AC, 50/60 Hz
Output: 24V DC, 2.5 A (192 watts) PF .95
Dimming: MLV, ELV and 0-10V dimmers
Dimming Range: 100% to 0.1%
Certifications: cUL certified and Class 2 protected
Rated: For dry, damp and wet locations
 - Adjustable Output Voltage: 17V to 25V
 - Adjustable PWM Frequency 4k - 20k Hz (flicker-free)
 - No minimum load requirement

Dimensions:

Length: 218 mm. (8.6 in)
Width: 120.5 mm. (4.7 in)
Height: 42 mm. (1.7 in)
Weight: 1274 g (2.81 lbs)

SKU	Finish	Power
1552-ps-dim-24v192w	Black	192w 24v

More power supply options are available at : www.lumicrest.com

SAFETY & WARNINGS

1. Install in accordance with national and local electrical code regulations.
2. This product is intended to be installed and serviced by a qualified, licensed electrician.
3. Ensure applicable wire is installed between driver, fixture, and any controls in-between. When choosing wire, factor in voltage drop, amperage rating, and type (in-wall rated, wet location rated, etc.). Inadequate wire installation could overheat wires, and cause fire.
4. Do not install in environment where LED chips are exposed to direct sunlight as damage to the phosphor will occur.
5. Do not install in environment where excessive heat may exist (ex. close proximity to fireplace, etc.) See Ambient Temperature ratings
6. Do not install indoor LED tape light products in outdoor / wet location environments. Only wet location tape light models are rated for outdoor / wet locations.
7. Do not modify product beyond instructions or warranty will be void.
8. Tape light must be handled with care. Excessive handling, bending, and pressure may damage the product, voiding the warranty.
9. Actual color may vary from what is pictured on this sheet and other print materials due to the limitations of photographic processes.
10. We reserve the right to modify and improve the design of our fixtures without prior notice. We cannot guarantee to match existing installed fixtures for subsequent orders or replacements in regards to product appearance, CCT, or lumen output.

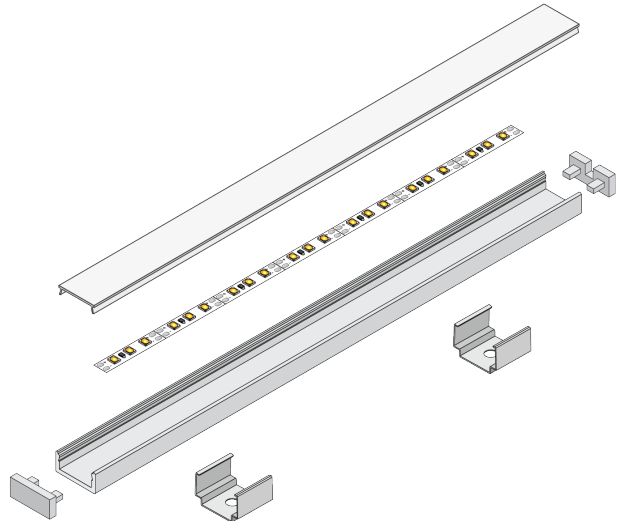

Contents

Step 1. Determine Tape Light & Channel Length	pg. 2
Step 2. Cut Channel and Cover	pg. 2
Step 3. Clean Channel and Adhere Tape Light	pg. 2
Step 4. Assemble Fixture	pg. 3
Step 5a. Mounting (Mounting Clips)	pg. 3
Step 5b. Mounting (Direct Mounting)	pg. 4
Step 5c. Mounting (Millwork / Recessed)	pg. 4
Channel Dimensions	pg. 7

Tools For Install

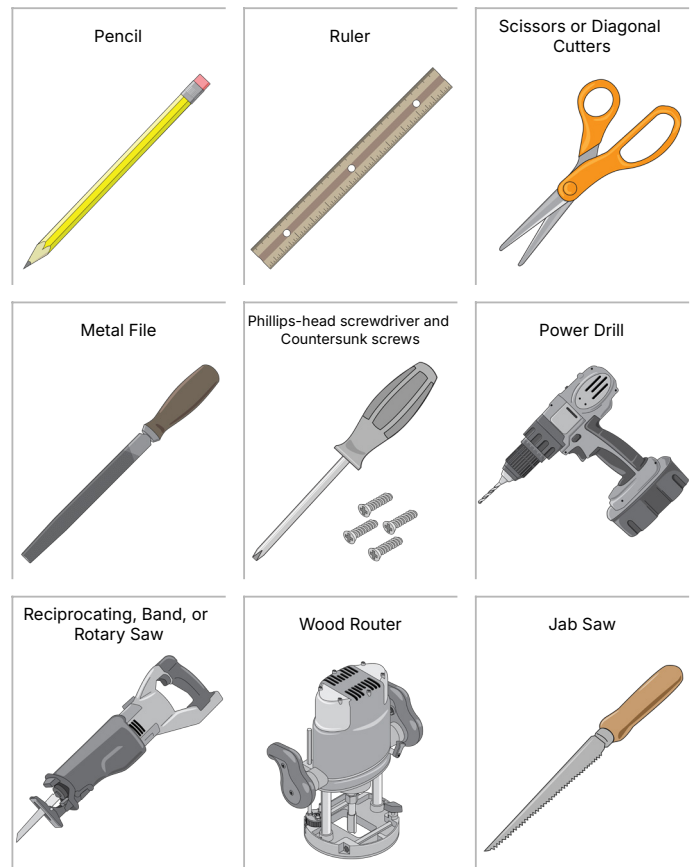

TEST CONNECTION

Prior to assembling fixture, connect tape light to Class 2 LED driver and turn on power. Ensure connection is secure and system is working properly. Turn off power again before mounting. See tape light installation guide for information on powering fixture.

1. Determine Tape Light & Channel Length

1.1 - Determine Total Tape Light Length

Cut to desired length using scissors or diagonal cutters (cut at scissors icon) If applicable, attach appropriate connectors, which will slightly extend total length.

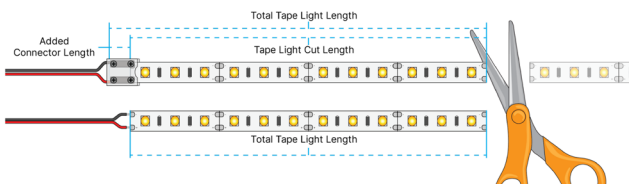

1.2 - Determine Channel / Cover Cut Length

Add 1 inch to the Total Tape Light Length to determine the Channel / Cover Cut Length. This will provide space to fit end cap harness.

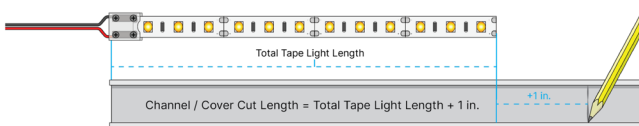

1.3 - Determine Total Fixture Length

Add the total length of both end caps to the Channel / Cover Cut Length to determine the total length of the Fixture.

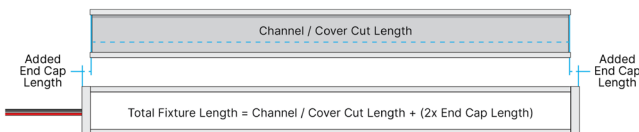

2. Cut Channel and Cover

Aluminum Channels

Channels can be cut to size with a bandsaw, reciprocating saw, rotary saw, or handsaw fitted with an appropriate blade to cut metal objects. Once cut, finish edges with metal file.

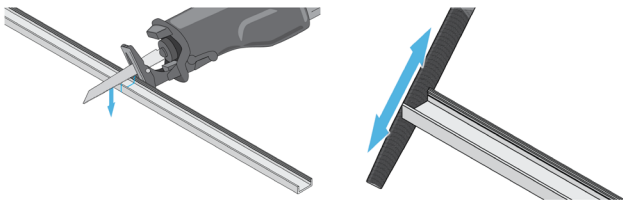

Channel Covers

Covers can be cut to size with heavy duty scissors, diagonal cutters, or a saw.

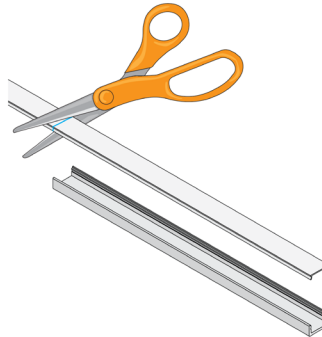

3. Clean Channel and Adhere Tape Light

3.1 - Run an alcohol wipe along the inside of the channel to remove any dust or debris. Wipe with dry towel then let dry.

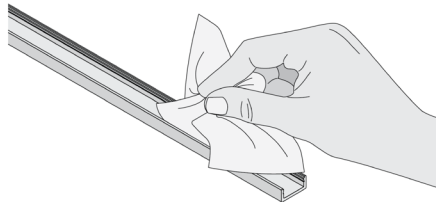

3.2 - Peel off adhesive backing from Tape Light

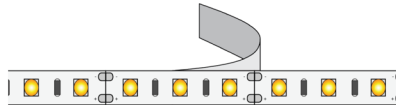

3.3 - Press Tape Light gently but firmly against channel, taking care not to press directly on LEDs.

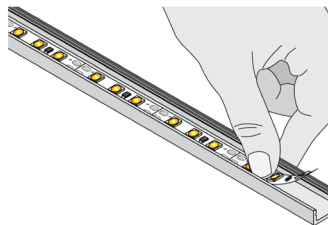

4. Assemble Fixture

4.1 - Bridge Channels

To bridge between two channels, lay channels end-to-end, then place cover over gap to keep ends flush.

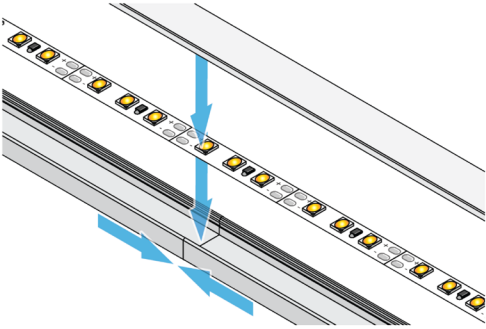

4.2 - Insert Cover

Fasten cover by firmly pressing one edge into channel, then the other.

Continue pressing in lens along channel until fully seated.

Flat Channel Cover

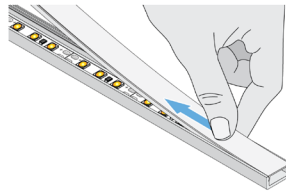
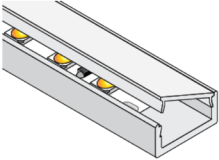

Angled Channel Cover

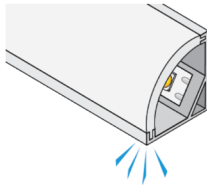
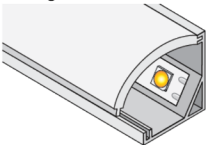

4.3 - Connect End Caps

Attach end caps and adhere with adhesive or glue if desired.

Open End Cap

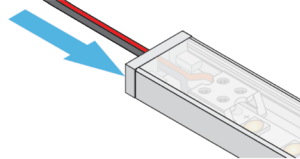

Closed End Cap

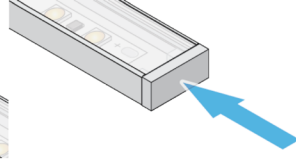

5a. Mounting (Mounting Clips)

5a.1 - Draw Guide Line

Draw guide line with ruler and pencil.

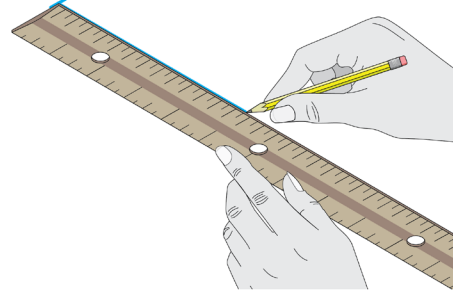

5a.2 - Fasten Mounting Clips

Mark holes. Use one clip for every two feet of channel. Fasten with countersunk screws w/screwdriver or drill.

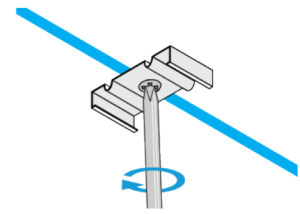
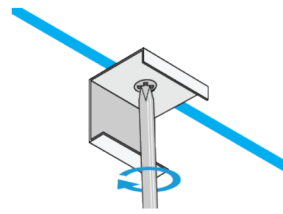
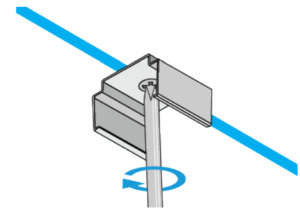
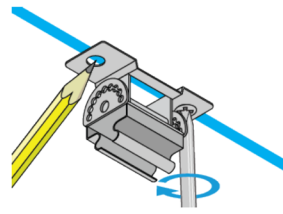
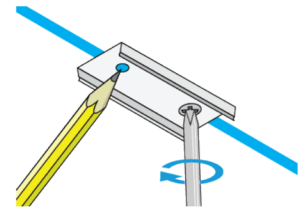
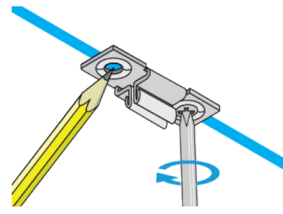

5d. Mounting (Mud-In)

5d.1 - Insert Cover

Fasten cover by firmly pressing one edge into channel, then the other. Continue pressing in lens along channel until fully seated.

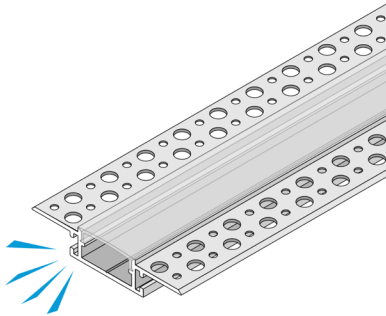

5d.2 - Assembly Option - Extension

Place extension pieces into each side of channel, then slide both channels end-to-end.

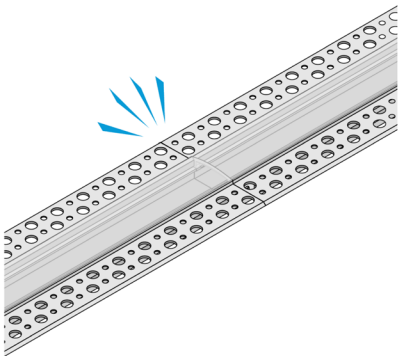
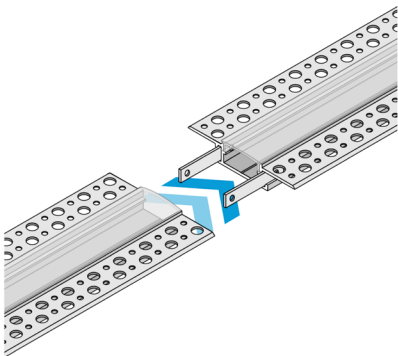

Using hex key, fasten extension pieces to channels.

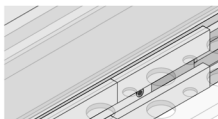

5d.3 - Cut Channel Mount Area

Cut channel mount area into surface matching the length and width* of channel. Allow for channel wings to rest on outside of area.

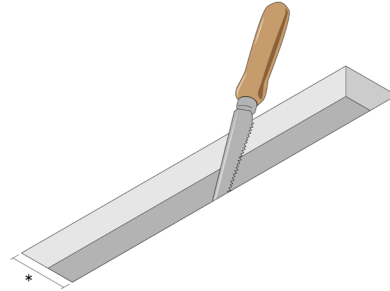

*Channel width varies between models.

1-Inch Mud-In Channel: 1.19 in.

2-Inch Mud-In Channel: 1.97 in.

5d.4 - Mount Channel

Thread lead wire into wall through back of channel mounting area, then insert channel.

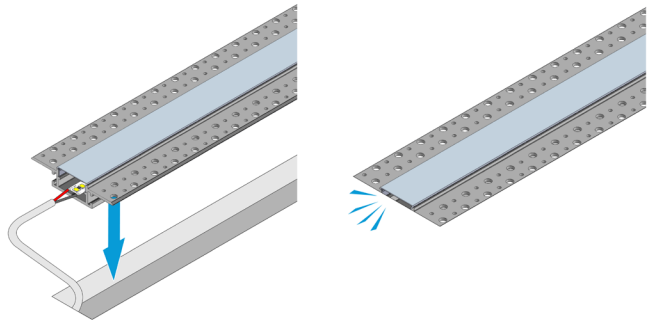

Optional: For added stability, you may fasten channel to surface using countersunk screws.

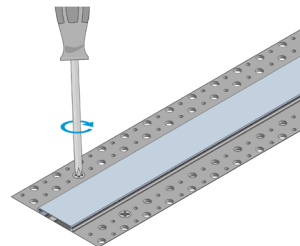

5d.5 - Mud-In Channel

Cover center of channel with painters tape.

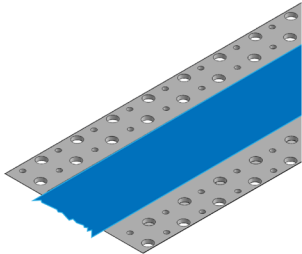

Cover wings of channel with drywall tape.

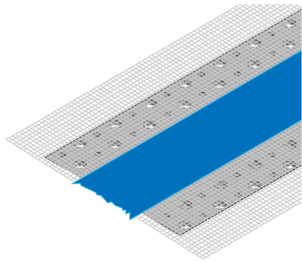

Cover wings of channel with drywall mud.

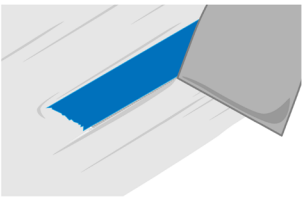

Once mud is dry, remove painters tape.

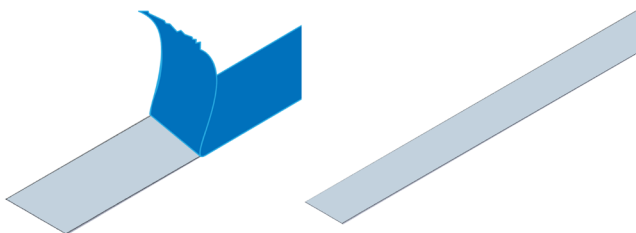

Channel Dimensions

<p>A1</p> <p>Height (H): 0.81 in. Width (W): 0.87 in. Interior Depth (ID): 0.45 in. Interior Width (IW): 0.79 in.</p>	<p>A2</p> <p>Height (H): 0.55 in. Width (W): 0.63 in. Interior Depth (ID): 0.33 in. Interior Width (IW): 0.49 in.</p>	<p>A3</p> <p>Height (H): 0.39 in. Width (W): 0.63 in. Interior Depth (ID): 0.33 in. Interior Width (IW): 0.49 in.</p>	<p>S1</p> <p>Height (H): 0.31 in. Width (W): 0.67 in. Interior Depth (ID): 0.25 in. Interior Width (IW): 0.58 in.</p>	<p>S2</p> <p>Height (H): 0.57 in. Width (W): 0.74 in. Interior Depth (ID): 0.34 in. Interior Width (IW): 0.63 in.</p>	<p>S45</p> <p>Height (H): 0.78 in. Width (W): 0.78 in. Interior Depth (ID): 0.54 in. Interior Width (IW): 0.6 in.</p>	<p>Slim</p> <p>Height (H): 0.38 in. Width (W): 0.82 in. Interior Depth (ID): 0.3 in. Interior Width (IW): 0.67 in.</p>
<p>Square</p> <p>Height (H): 0.55 in. Width (W): 0.82 in. Interior Depth (ID): 0.27 in. Interior Width (IW): 0.67 in.</p>	<p>45°</p> <p>Height (H): 0.94 in. Width (W): 0.67 in. Interior Depth (ID): 0.32 in. Interior Width (IW): 0.67 in.</p>	<p>Recessed</p> <p>Height (H): 0.49 in. Width (W): 1.03 in. Interior Depth (ID): 0.42 in. Interior Width (IW): 0.59 in. Cut Out Width (CO): 0.74 in. Recessed Wing (RW): 0.15 in.</p>	<p>20mm Square</p> <p>Height (H): 1.18 in. Width (W): 1.18 in. Interior Depth (ID): 0.84 in. Interior Width (IW): 0.84 in.</p>	<p>20mm Round</p> <p>Height (H): 1.18 in. Width (W): 1.18 in. Interior Depth (ID): 0.84 in. Interior Width (IW): 0.84 in.</p>	<p>Sconce</p> <p>Height (H): 1.1 in. Width (W): 1.21 in. Interior Depth (ID): 0.53 in. Interior Width (IW): 0.84 in.</p>	<p>45° Deco</p> <p>Height (H): 0.73 in. Width (W): 0.73 in. Interior Depth (ID): 0.42 in. Interior Width (IW): 0.47 in.</p>
<p>90° Sideview</p> <p>Height (H): 0.92 in. Width (W): 0.92 in. Interior Depth (ID): 0.3 in. Interior Width (IW): 0.48 in. Mounting Canal (MC): 0.25 in.</p>	<p>16mm Square</p> <p>Height (H): 0.89 in. Width (W): 0.77 in. Interior Depth (ID): 0.58 in. Interior Width (IW): 0.63 in.</p>	<p>Grazer</p> <p>Height (H): 0.69 in. Width (W): 0.62 in. Interior Depth (ID): 0.45 in. Interior Width (IW): 0.42 in. Height W/o Cover (H/C): 0.47</p>	<p>Waveform</p> <p>Height (H): 0.3 in. Width (W): 0.71 in. Interior Depth (ID): 0.25 in. Interior Width (IW): 0.49 in. Height W/o Cover (H/C): 0.2 in.</p>	<p>1-inch Mud-In</p> <p>Height (H): 0.54 in. Width (W): 2.42 in. Interior Depth (ID): 0.44 in. Interior Width (IW): 0.81 in. Cut Out Width (CO): 1.19 in.</p>	<p>2-inch Mud-In</p> <p>Height (H): 0.8 in. Width (W): 3.86 in. Interior Depth (ID): 0.69 in. Interior Width (IW): 1.84 in. Cut Out Width (CO): 1.97 in.</p>	<p>Reflector</p> <p>Height (H): 2.75 in. Width (W): 1 in. Interior Depth (ID): 0.29 in. Interior Width (IW): 0.54 in. Cut Out Width (CO): 2.35 in. Recessed Wing (RW): 0.2 in.</p>
<p>ROD</p> <p>Height (H): 0.95 in. Width (W): 0.95 in. Interior Depth (ID): 0.5 in. Interior Width (IW): 0.48 in. Height W/o Cover (H/C): 0.72</p>	<p>Slim Recessed</p> <p>Height (H): 0.38 in. Width (W): 0.65 in. Interior Depth (ID): 0.28 in. Interior Width (IW): 0.4 in. Cut Out Width (CO): 0.49 in. Recessed Wing (RW): 0.08 in.</p>					